

Location of the Overholser Pavilion

(35° 29' 00" N; 97° 39' 51.3" W)

The Overholser Pavilion is off of NW 10th (between Council and County Line Rds). From 10th, turn onto Eagle Lane then immediately veer left onto East Overholser Drive. Go north about 0.28 miles and the Pavilion will be on your right. If you go past the dam, you've gone too far.

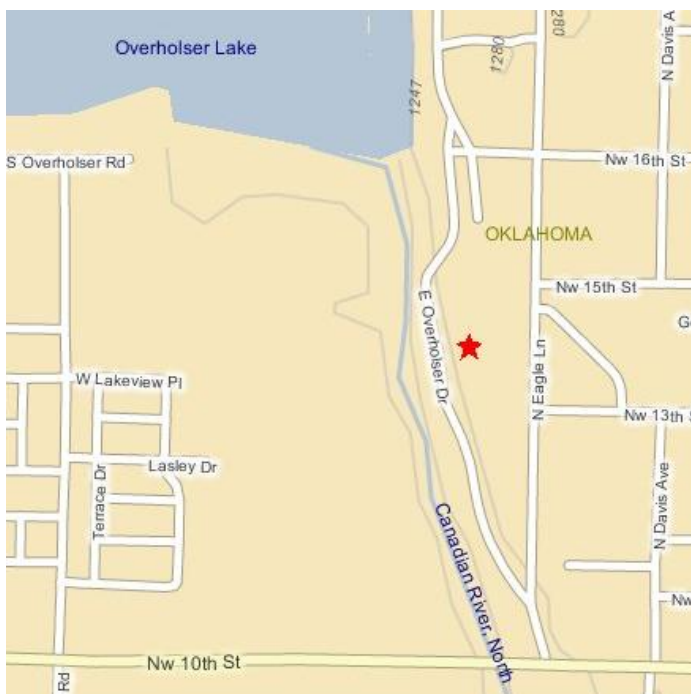
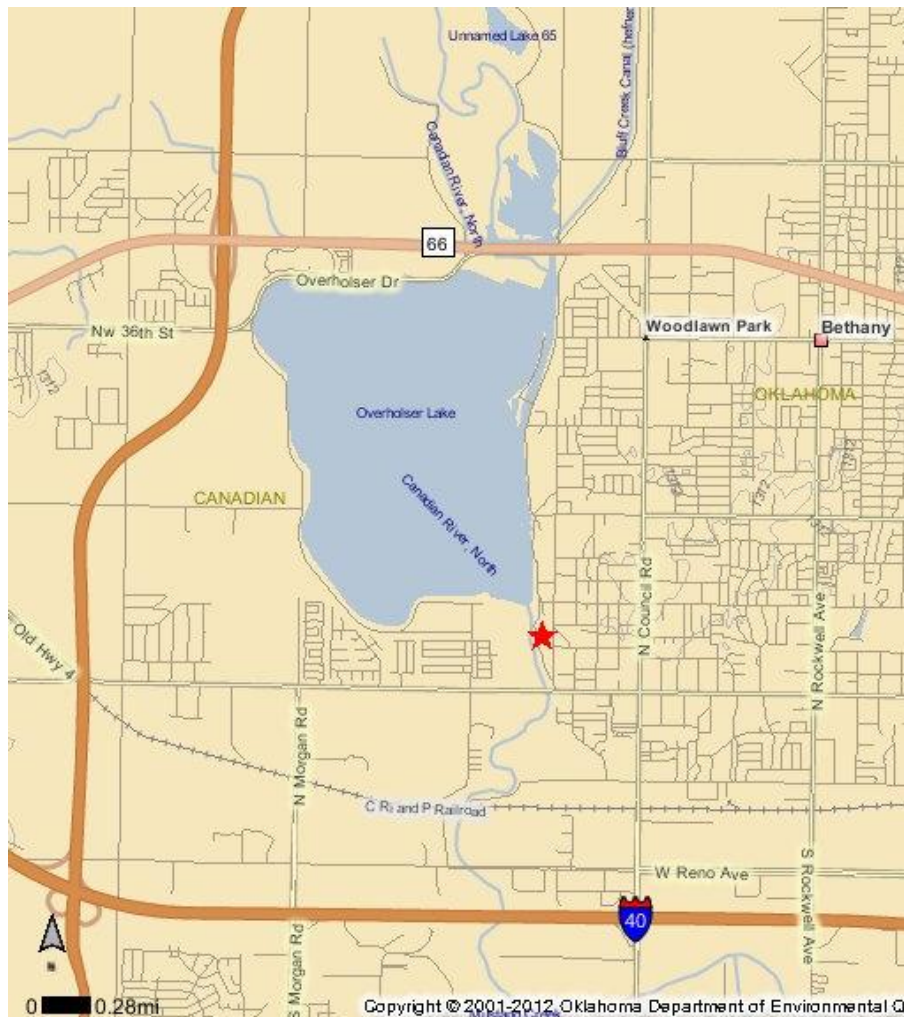

Some volunteers at the Pavilion